



Having correctly sized images on your website helps improve the user experience.

When images are low-quality, pixelated, or too small, they can impact the perceived quality of your content. This could lead to clients questioning the quality of your business.

Conversely, high-quality, correctly sized images deliver more visual information to potential clients.

### **JPEG or PNG?**

JPEG (or JPG) is one of the most widely used digital image file formats because it offers a balance between file size and image quality. However, JPEG uses lossy compression, which means some image quality is lost when the image is compressed.

PNG is a lossless compression format, meaning it reduces file size without sacrificing image quality. While PNGs often have larger file sizes than JPEGs, their ability to retain their clarity makes them suitable for detailed graphics and logos.

### **Landscape or Portrait?**

It's something that gets overlooked an awful lot, but it's always best to provide landscape pictures - not portrait. We kindly ask that you please submit landscape photos.

If you have beautiful photos, but it's in portrait, you are welcome to place two/three portraits next to each other and save it as a new landscape image (not recommended for the Snapshot and Slider gallery)

We recommend a 1600 x 1067px size photo. If you are unsure if your photo is the right size, please see steps on the next page which will help you.

### **When will my photos get rejected?**

- When you upload screenshots
- Non-Professional looking photos
- Low quality, pixelated photos
- Portrait orientation
- Photos with watermarks from the internet
- Photos not relevant to the tag

## Correct photo size:

**Step 1:** Click [here](#) to open the Canva link.

**Step 2:** Click on Use template for a new design.

**A template created by Maryke van der Ryst was shared with you, start designing now**

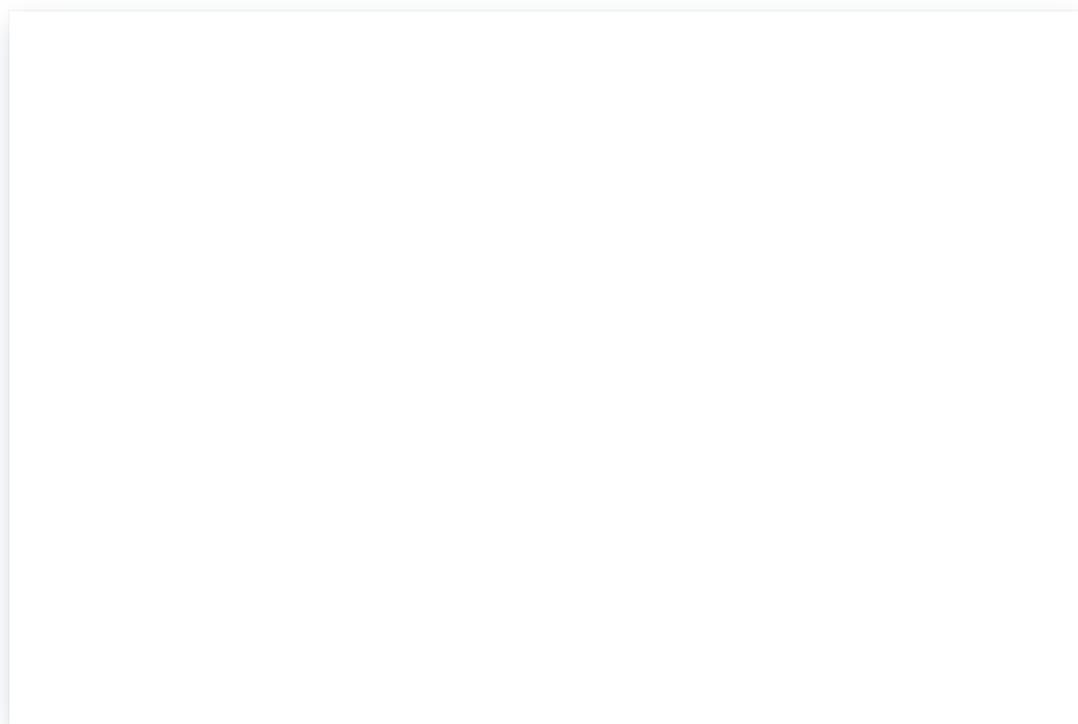

1600 × 1067 px

Edit template

Use template for new design

Designed with *Canva*

**Step 3:** Upload your photo(s)



## Correct photo size:

**Step 4:** Click on your uploaded photo on the left.

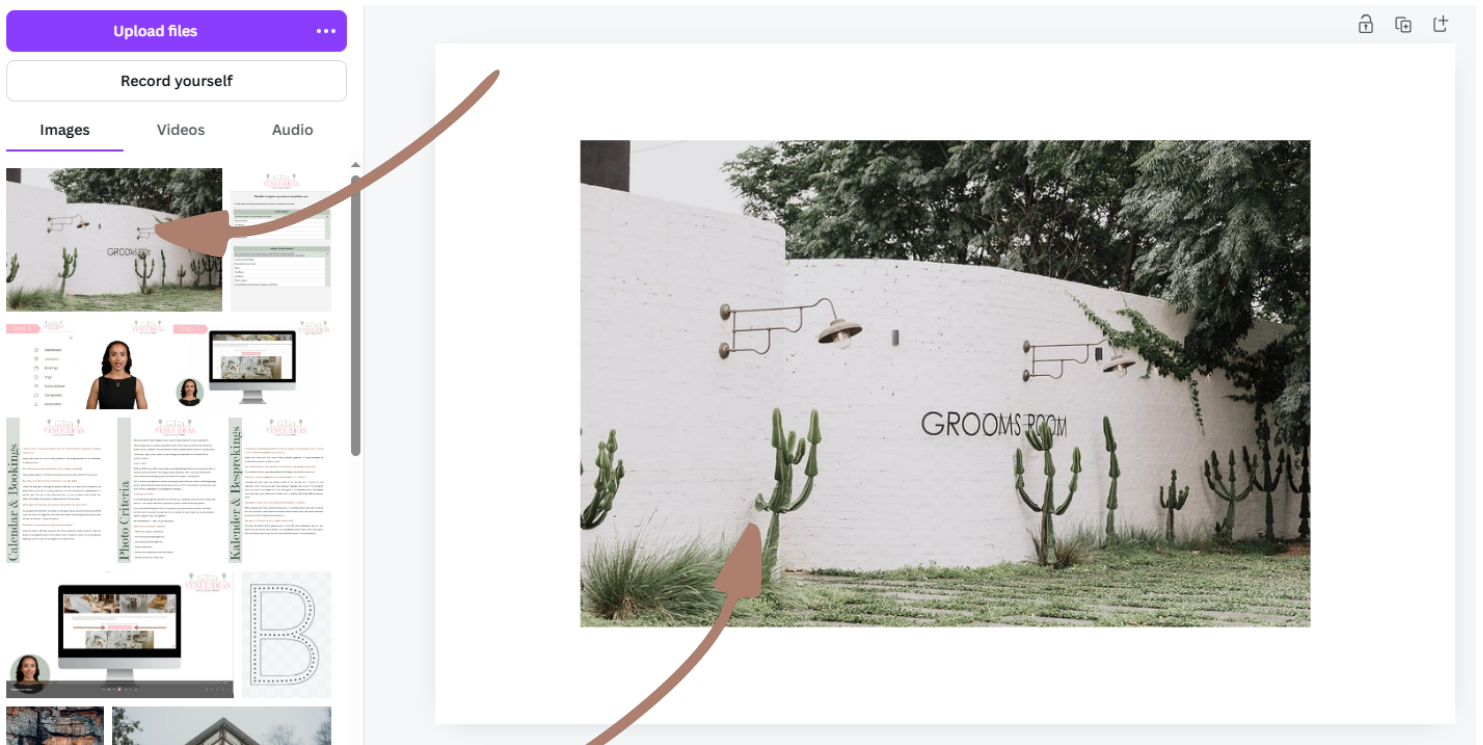

**Step 5:** Right click on your photo and select “Set Image as background”

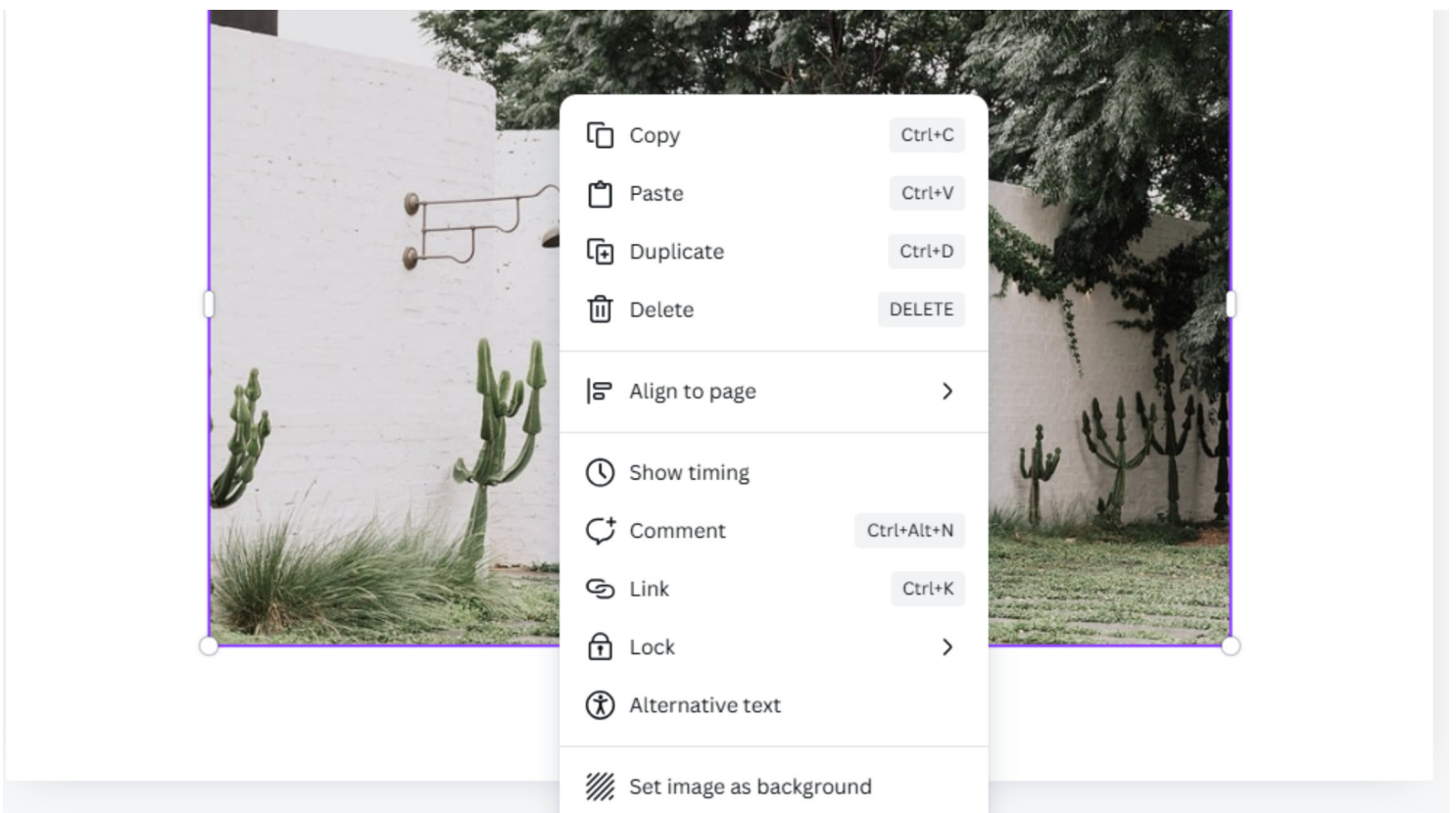

## Correct photo size:

**Step 6:** At the top right corner of the photo, click on the middle icon and duplicate this page.

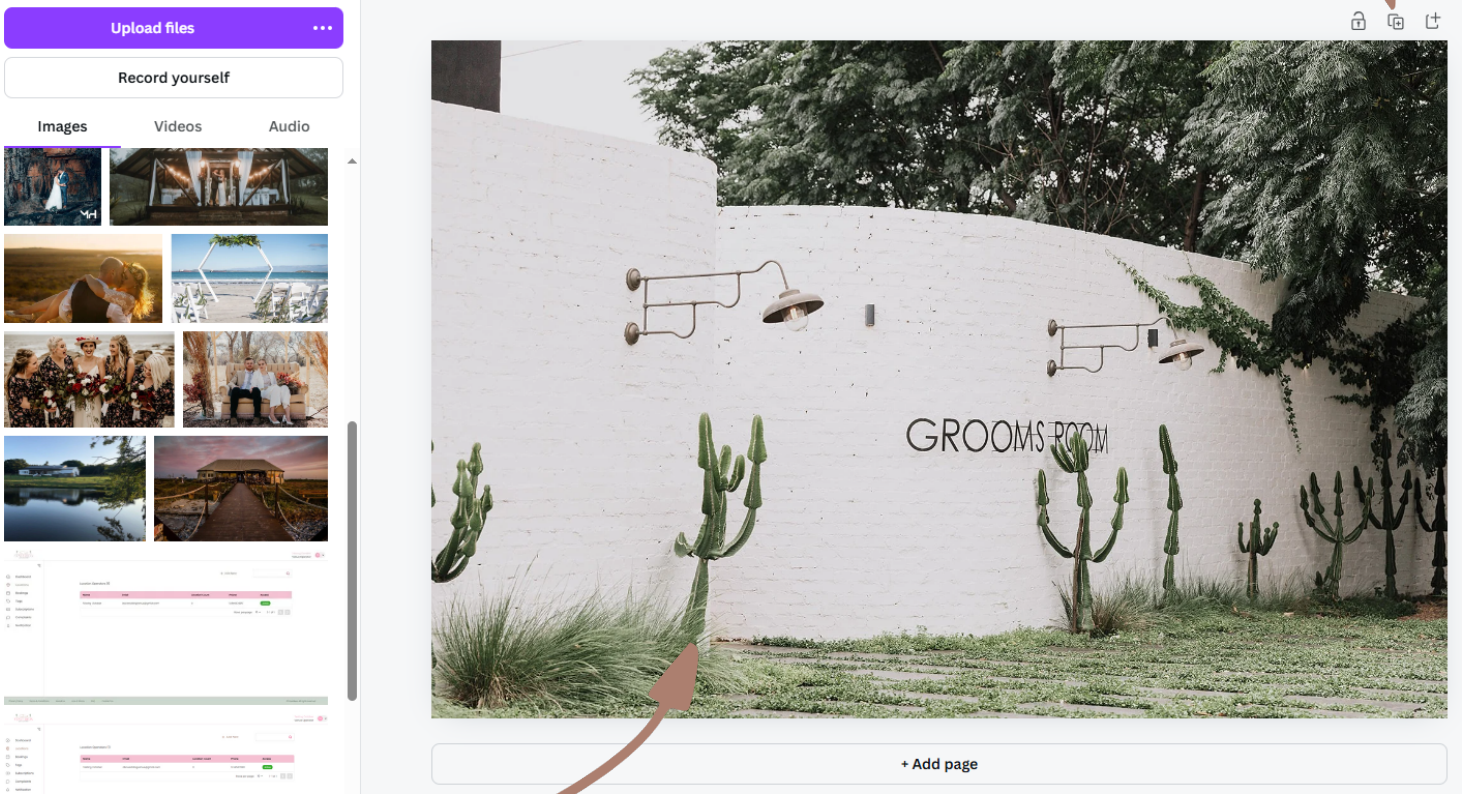

**Step 7:** Just drag your next photo from the gallery over to the page. Repeat this step until you have all your photos.

**Step 8:** Download your photos

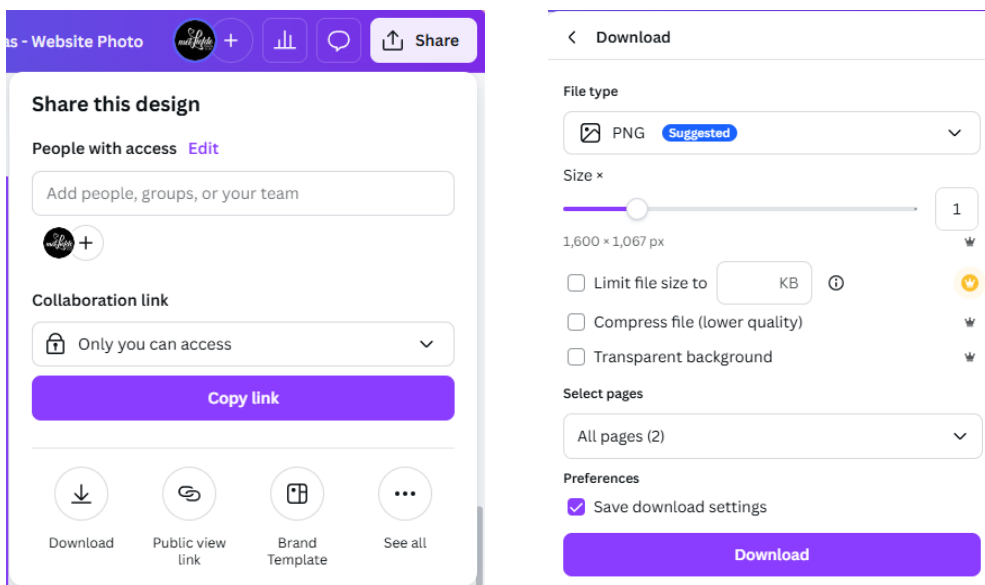

Click on share → download → PNG (file type) → All pages → Download

The photos you upload here:

## Profile

### Location Details

Name *	Address *	
<input type="text"/>	<input type="text"/>	
Town	City	
<input type="text"/>	<input type="text"/>	
Province		
<input type="text"/>		
Description *		
<input type="text"/>		
Minimum Capacity *	Maximum Capacity *	Other Photos
<input type="text"/>	<input type="text"/>	<input type="button" value="Edit Photo"/>
Social Media Links		
Website Link	Instagram Link *	
<input type="text"/>	<input type="text"/>	

will display here:

### Slots and Packages

Standard Days

### Snapshots



and as a slide here on the venue list:

4	<b>Test Prod Second 8</b>	Active / Trial
	Rietfontein, Hartbeespoort, North West	
	★★★★☆ 4 (1 reviews)	
	0 - 0 / Guest  10 - 100	Managed by <b>Test Location</b>



# The photos you upload here:

## Amenities

[Basic Facilities](#) [Special Facilities](#) [Family and Kids](#) [Food and Beverages](#) [Wedding Special](#) [Photography Opportunity](#) [Opera](#) >

Basic Facilities (Please make sure to click on Save button to reflect the changes)

Spaces Available Indoor ▾

Chapel ⓘ Approved [Edit Photo](#)

Ceremony ⓘ Approved [Edit Photo](#)

Accommodation at the venue ⓘ Approved [Edit Photo](#)

Staff included

Tables

Chairs

Decor - Standard

Style and Aesthetics ▾

Parking

Disability

will display here:

< Test Prod Second 8

8

< >

[Overview](#) [Amenities](#) [Slots and Packages](#) [Other Photos](#) [Ratings and Reviews](#)

**Test**

📍

★★★★☆ 4 (1 reviews)

👤 10-100

Manager Details

Test Location [1234567890](#)